

AREA STATEMENT

1. LAND AREA - 19065 SQ.M / 20506 SQ.FT. / 28.48 Katha
2. GROUND FLOOR - 731.54 SQ.M / 7871.37 SQ.FT.
3. 1ST FLOOR TO 20TH FLOOR (TYPICAL) - 731.54 SQ.M / 7871.37 SQ.FT. (EACH FLOOR)
4. PROPOSED TOTAL BUILT UP AREA - 15362.59 SQ.M. / 1,65,301.46 SQ.FT. (INCLUDING CAR PARKING)
5. TOTAL BUILT UP AREA FOR F.A.R. - 12929.00 SQ.M. (EXCLUDING CAR PARKING & SERVICES AT EACH FL.)
6. FLOOR AREA RATIO - 0.68
7. PARKING AT GROUND FL. - 679.01 SQ.M.
8. SERVICES IN GROUND FLOOR - 52.53 SQ.M.
9. SERVICES AT EACH FL. - 85.09 SQ.M.
10. GROUND COVERAGE - 3.84 %

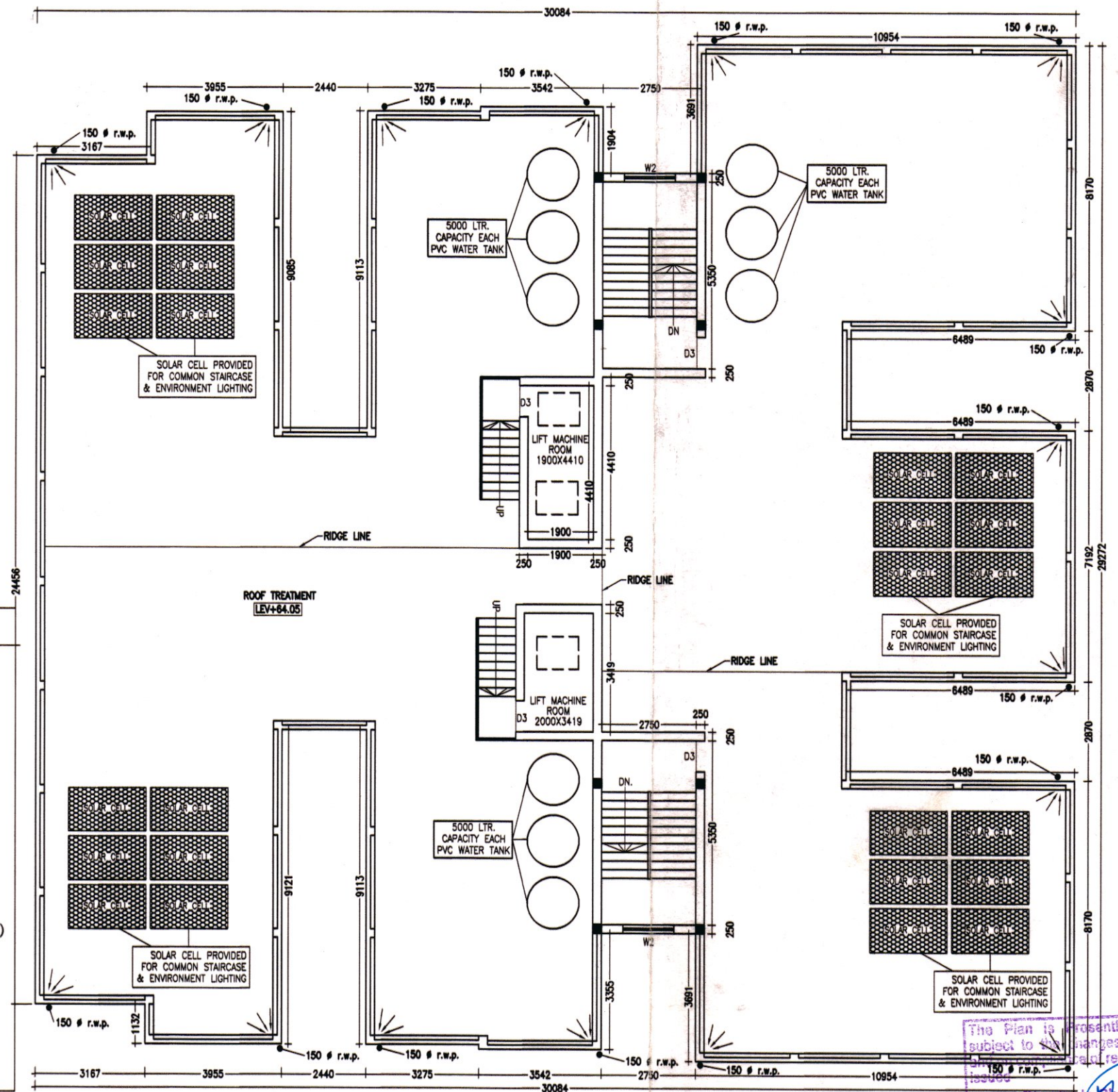

- ALL DIMENSIONS ARE IN M.M. AND ALL LEVEL ARE IN M.
WRITTEN DIMENSIONS MUST BE FOLLOWED.
OWNERS PLOT SHOWN IN RED COLOR
1. ALL EXTERNAL WALLS 250TH. & INTERNAL WALLS 125 THK. UNLESS OTHERWISE MENTIONED.
 2. ALL MASONRY WORKS ARE BOUNDED BY CEMENT MORTAR (1:6) & (1:4).
 3. EXTERNAL PLASTER IS 25THK. & INTERNAL PLASTER IS 15MM THK.
 4. ALL CONC. GRADE IS M25 & AND GRADE OF STEEL FE-500
 5. 250 THK. BRICK WORK IN 1:6 MORTAR
 6. 125 THK. & 75 THK. BRICK WORK IN 1:4 MORTAR
 7. 150 WIDE SURFACE DRAIN SHOULD BE PROVIDED ALL ROUND THE BUILDING.
 10. 25% OF THE BUILDING TO BE CONSTRUCTED USING FLY-ASH BRICKS

DOORS AND WINDOWS SCHEDULE

TYPE	WIDTH	HEIGHT	REMARKS
D1	1050	2100	PANEL DOOR
D2	900	2100	DO
D3	900	2100	FLUSH DOOR
D4	750	2100	DO
D5	750	2100	P.V.C DOOR
W2	1500	1300	GLAZED SHUTTER
W3	1200	1300	DO
V1	750	600	DO

PROJECT NAME

PROPOSED PLAN OF G+20 STORIED RESIDENTIAL APARTMENT BUILDING OF 'AMRITA INFRA DEVELOPER' OVER R.S. PLOT NO. - 1377, 1379, 1377/5035, L.R. PLOT NO. - 1059,1060,1062, KHATIAN NO.- 6726, 6727, 6731, 6732, 6733, 6707, 6705. MOUZA - BAMUNARA, J.L. NO- 058, P.S. - KANKSA, DIST- PASCHIM BARDHAMAN.

OWNER'S NAME-

1. SRI PANKAJ MUKHERJEE
2. SMT. MALAYA MUKHERJEE
3. SRI MAHADEV PAUL
4. SMT. SONALI PAUL
5. AMRITA GREEN VIEW HOUSING PRIVATE LIMITED

SIGNATURE OF OWNER

D. Paul

Malaya Mukherjee

Maha dev Paul.

Sonali Paul.

Amrita Green View Housing Pvt. Ltd.
Maha dev Paul. Director

SIGNATURE OF GEO-TECHNICAL ENGINEER

Alok Roy

ALOK ROY
Empanelled Geotechnical Engineer
Kolkata Municipal Corporation
Class-1, No.- G.T/11
GA, Milan Park,
Kolkata-700 084

SIGNATURE OF ARCHITECT

Vijaya Singh Mazumder

Ar. VIJAYA SINGH MAZUMDER
COA Registered
CA/2021/134276
9332802166 / 9476426108

SIGNATURE OF PANCHAYAT PRADHAN

APPROVED

Gopalpur Gram Panchayat

Gopalpur Gram Panchayat
P.S.-Kanksa, Dist.-Paschim Bardhaman,
Vide memo no. 679/PSBZ/2021 dt. 24.02.2021
W.B. Fire & Environment Deptt.,
Paschim Bardhaman. Sd/- Pradhan

CHECKED BY T. E. C.

APPROVED BY T. E. C.

DATE: 21.08.2022

SHEET NO.-MN/APT(PANC)/2022-11/AMR20/A1